

Christopher Payne

Camera, Live Audio, Editing, Engineering, Networking

910 St Andrews Drive, APT L14
Murfreesboro, TN 37132
(615) 585-2791 :: chris.e.payne@gmail.com

Engineering Projects

I have been part of many projects that deal with the realm of video system engineering, but did not only give me a great deal of experience with analog video systems, but they are also some of the most prominent projects that I have worked on. These two projects not only helped me with my personal experience, but will give the opportunity for other students many years from now gain experience and have opportunities to produce great television content.

MTTV Studio B Renovation

(Full Story can be found at
<http://studiobredux.blogspot.com>)

MTTV, Middle Tennessee Television, is an all student-run television station hosted on the campus of Middle Tennessee State University. Home to numerous Mass Communication students, MTTV produces content for the local cable channel, Comcast Channel 10, out of an old studio classroom used by the Mass Communication Department. However, the studio that MTTV operates out of was severely lacking up to date technology. Constant equipment failures plagued the students who regularly produced shows from this cramped studio. When the

chance came to upgrade the studio, students eagerly awaited the transformation. I was fortunate enough to be able to work along side the department engineers, Mark Parrish and Toffer King, on rebuilding the studio control room. After three months of renovating, installing, and configuring, the studio is now complete and is happily used by the students at MTTV to produce even better content due to the updated equipment.



Studio B Before...



Studio B After – Engineering and Tape

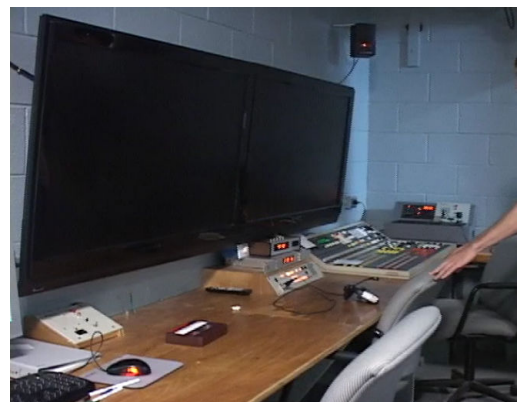

Monitor Wall, Director and TD Stations

MTTV Mobile Flight Pack



In 2007, work began on designing a mobile flight pack capable of multi-camera video production for MTTV. The idea of a multi-camera flight pack came out of the necessity of a mobile unit to produce content for the MTTV station. The majority of the content that would be produced using this mobile unit would be campus athletic games including basketball and volleyball matches. To date, numerous games have been covered using this mobile production unit.

Consisting of a NewTek Video Toaster 5 video switching system, Grass Valley DA's, Sony DVCAM Decks, and a multiplexed monitor wall system, the MTTV Flight Pack can handle up to five composite cameras, two component inputs, and has the capability of doing live sports score graphics and compositing. As being one of the major creators, I designed many aspects of this unit. One such design that has helped MTTV produce content at a fraction of the cost of most equipment prices, is the camera connection system. Based off a Cat5 Balun system, the camera connections for the flight pack use a single Cat5 cable to send composite video from, intercom, and a tally signal to the camera operator. Future plans are in place to also develop connections for POV cameras that also send power to the camera using the one Cat5 cable.

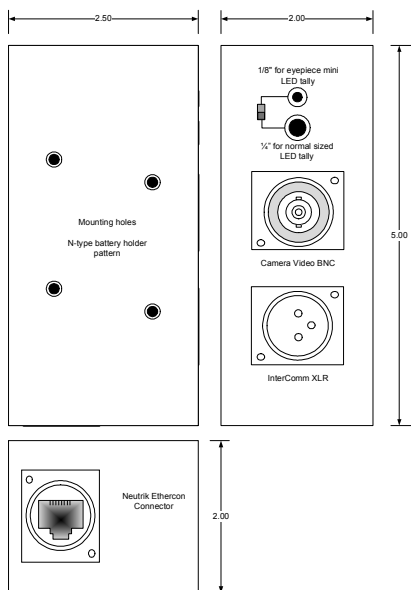

Cat5 Camera Transmitter

